

DOCUMENT:	PRODUCT SPECIFICATIONS	DOOR APPLICATION:	SINGLE	DRAWING SCALE:	3/4" = 1'-0" (1:16)	<div>KROWNLAB</div> <div>2351 NW York St.</div> <div>Portland, OR 97210</div> <div>+1 503 292 6998</div> <div>www.krownlab.com</div> <div>support@krownlab.com</div> <div><div><div>KROWNLAB</div><div>PDR · ORE</div></div></div>
SYSTEM:	IVAR	PANEL THICKNESS:	1-3/8" TO 1-3/4" (WITH AND WITHOUT TYPICAL DOOR TRIM)	UNITS:	INCHES	
MOUNTING STYLE:	FACE MOUNT	MAXIMUM WEIGHT:	UP TO 200LBS (CONTACT US FOR HEAVIER PANELS)	DATE:	3/6/2024	

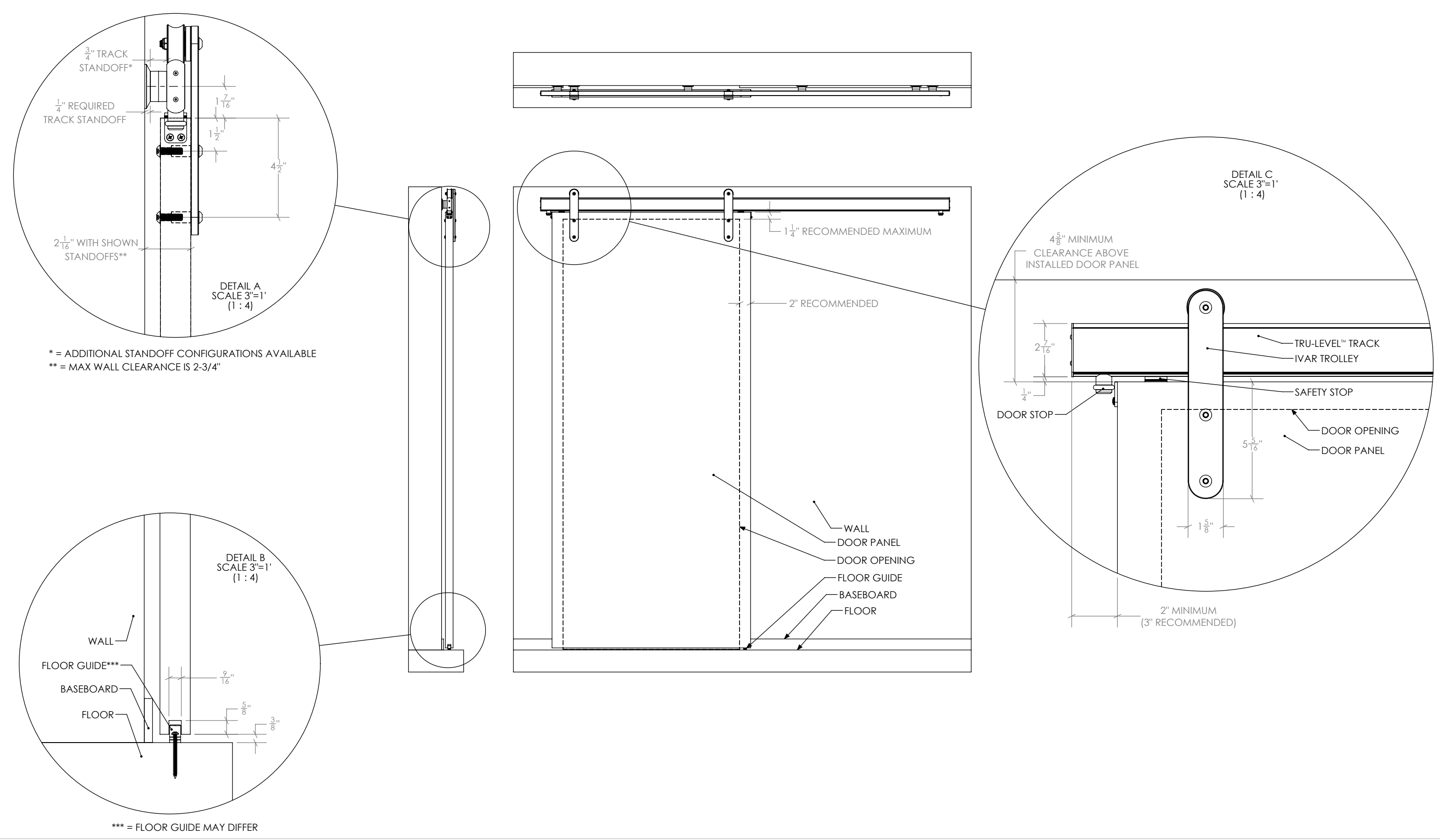

DOCUMENT:	PRODUCT SPECIFICATIONS	DOOR APPLICATION:	SINGLE	DRAWING SCALE:	4" = 1'-0" (1:3)	<div>KROWNLAB</div> <div>2351 NW York St.</div> <div>Portland, OR 97210</div> <div>+1 503 292 6998</div> <div>www.krownlab.com</div> <div>support@krownlab.com</div> <div><div><div></div></div><div>KROWNLAB</div><div>PDR · ORE</div></div>
SYSTEM:	IVAR	PANEL THICKNESS:	1-3/8" TO 1-3/4" (WITH AND WITHOUT TYPICAL DOOR TRIM)	UNITS:	INCHES	
MOUNTING STYLE:	FACE MOUNT	MAXIMUM WEIGHT:	UP TO 200LBS (CONTACT US FOR HEAVIER PANELS)	DATE:	3/6/2024	

WHAT'S INCLUDED:  
2 x - IVAR FACE MOUNT TROLLEY KIT  
1 x - FLOOR GUIDE KIT (FLOOR GUIDE MAY DIFFER - MULTIPLE OPTIONS EXIST)  
1 x - TRU-LEVEL™ TRACK SYSTEM WITH ALL MOUNTING HARDWARE (SEE SEPARATE PAGE)

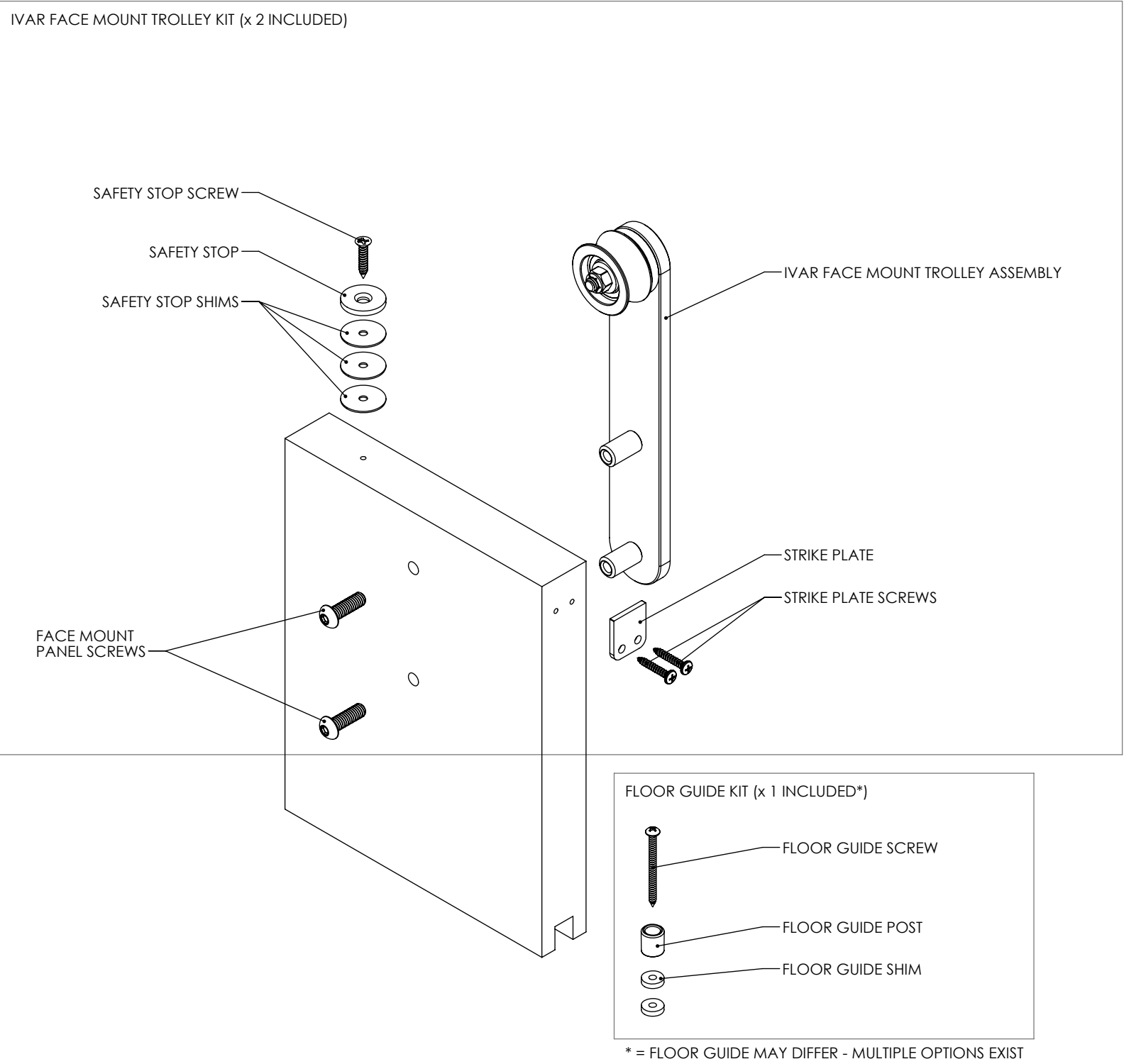
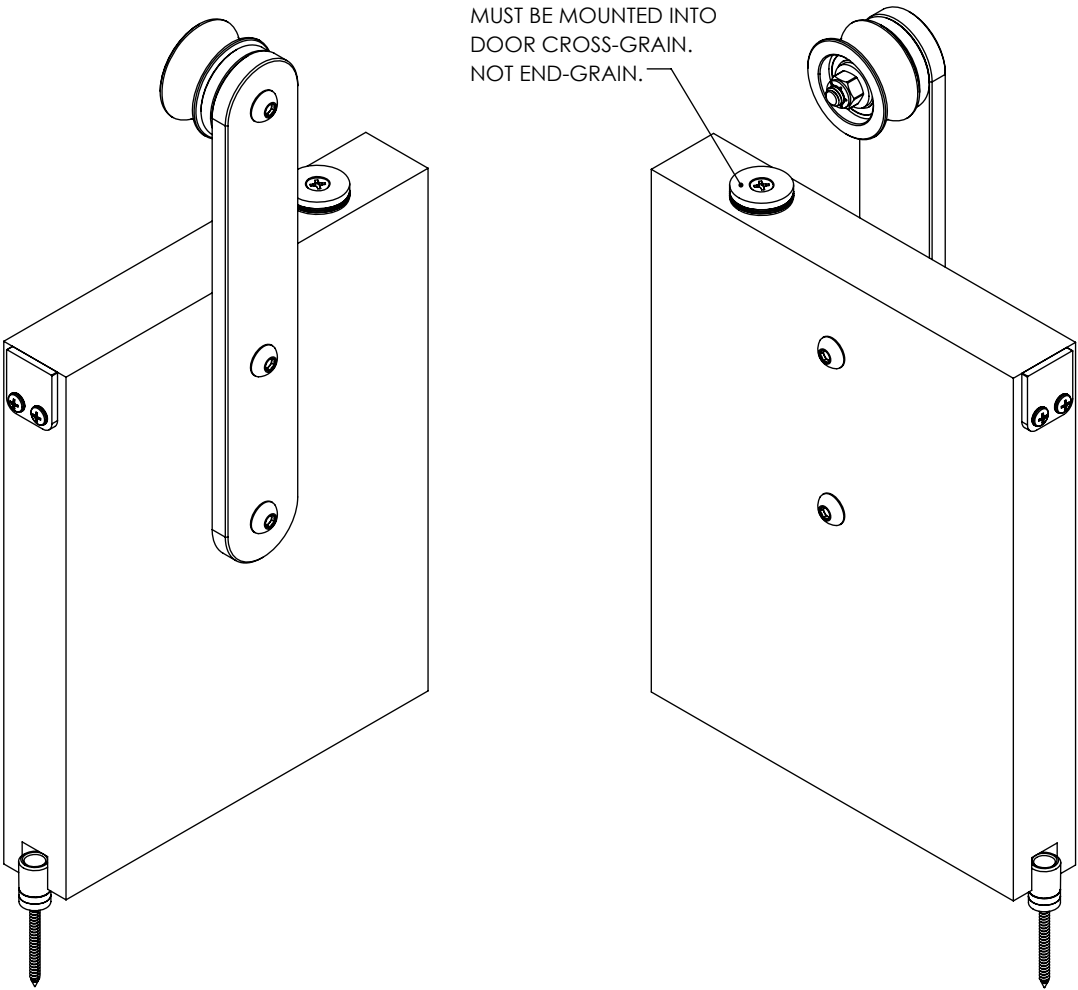

DOCUMENT:	PRODUCT SPECIFICATIONS - DOOR CONFIGURATIONS	DOOR APPLICATION:	SINGLE	DRAWING SCALE:	3/8" = 1'-0" (1:32)	<div>KROWNLAB</div> <div>2351 NW York St.</div> <div>Portland, OR 97210</div> <div>+1 503 292 6998</div> <div>www.krownlab.com</div> <div>support@krownlab.com</div> <div><div><div></div></div><div>KROWNLAB®</div><div>PDX · ORE</div></div>
SYSTEM:	TRU-LEVEL™ TRACK	PANEL THICKNESS:	TROLLEY SYSTEM OR TRACK CONFIGURATION DEPENDENT	UNITS:	INCHES	
MOUNTING STYLE:	FRAMED WALL	MAXIMUM WEIGHT:	TROLLEY SYSTEM OR TRACK CONFIGURATION DEPENDENT	DATE:	3/12/2018	

SINGLE

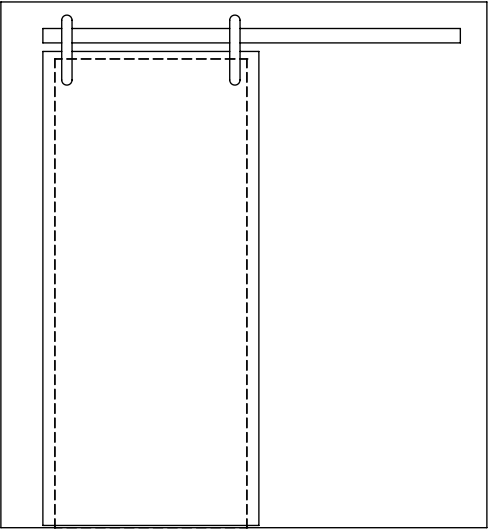

DOCUMENT:	PRODUCT SPECIFICATIONS	DOOR APPLICATION:	SINGLE, BI-PARTING, BYPASSING	DRAWING SCALE:	6" = 1'-0" (1:2)	<div>KROWNLAB</div> <div>2351 NW York St.</div> <div>Portland, OR 97210</div> <div>+1 503 292 6998</div> <div>www.krownlab.com</div> <div>support@krownlab.com</div> <div><div><div>KROWNLAB</div><div>FOK · GFE</div></div></div>
SYSTEM:	TRU-LEVEL™ TRACK	PANEL THICKNESS:	TROLLEY SYSTEM AND TRACK CONFIGURATION DEPENDENT	UNITS:	INCHES	
MOUNTING STYLE:	FRAMED WALL	MAXIMUM WEIGHT:	TROLLEY SYSTEM AND TRACK CONFIGURATION DEPENDENT	DATE:	11/16/2023	

WHAT'S INCLUDED:  
1 x TRU-LEVEL™ TRACK SYSTEM WITH ALL MOUNTING HARDWARE:  
X x TRACK MOUNT KIT  
2 x DOOR STOP KIT  
X x TRACK CONNECTOR KIT (1 x PER TRACK JOINT INLCUED)

DOOR STOP KIT (x 2 INCLUDED\*)

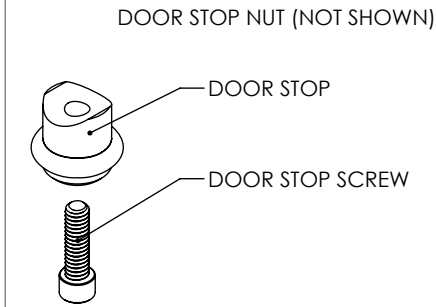

\* = THE DOOR STOP MAY DIFFER - MULTIPLE OPTIONS EXIST

TRACK SHIM KIT (SYSTEM ADD-ON)

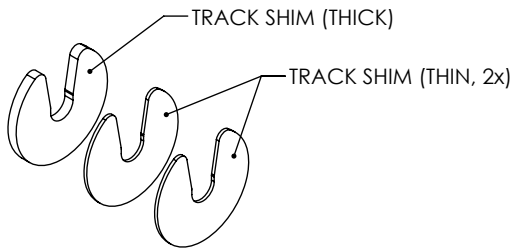

TRACK SHIMS ARE DESIGNED TO BE INSTALLED AGAINST TRACK

TRACK CONNECTOR KIT  
(1 x PER TRACK JOINT INLCUED)

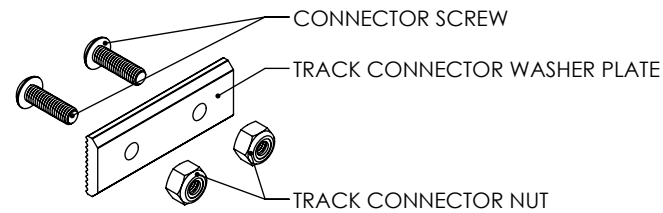

TRU-LEVEL™ TRACK SYSTEM

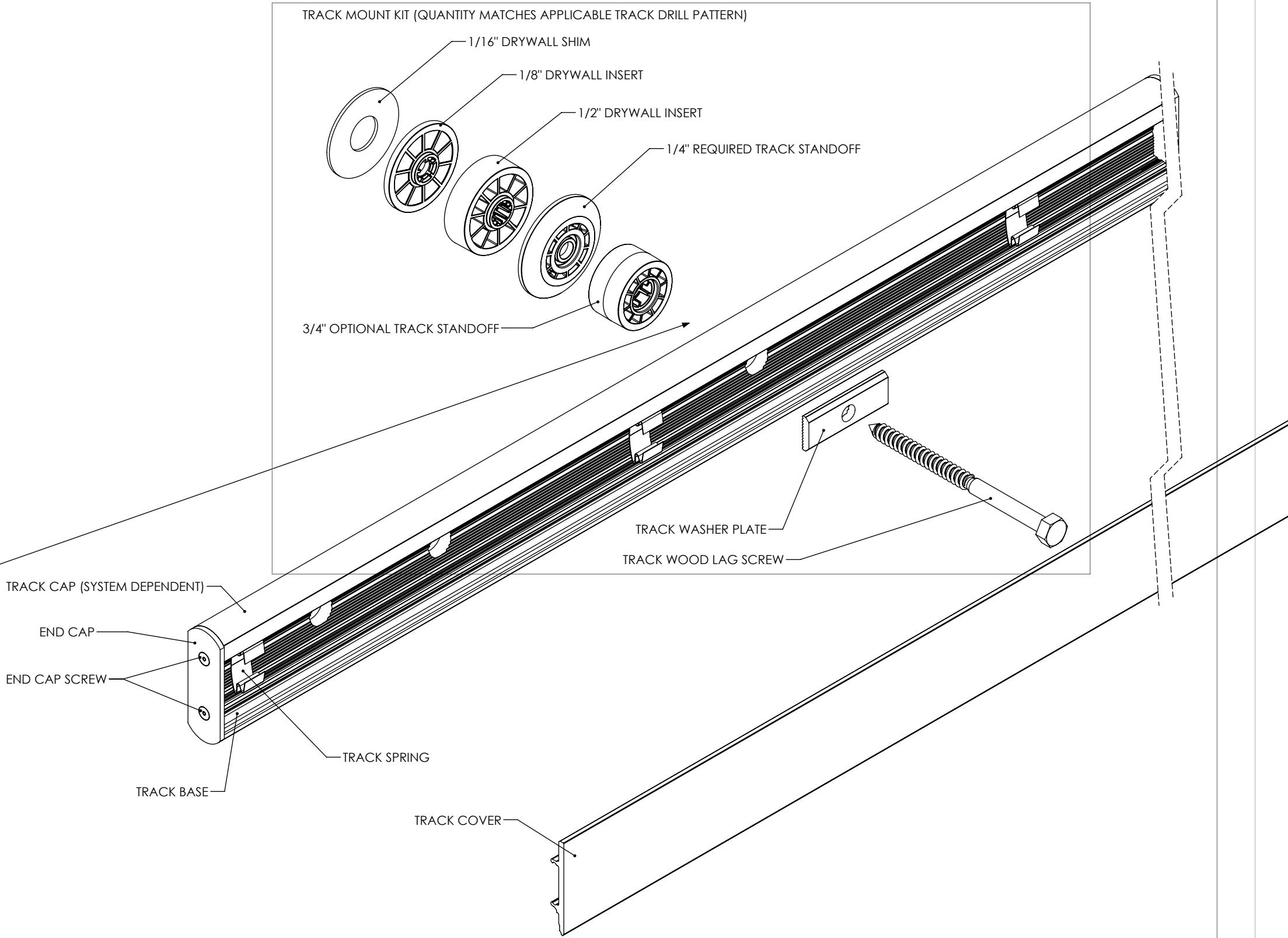

DOCUMENT:	PRODUCT SPECIFICATIONS - STANDARD TRACK MOUNTING POINT	DOOR APPLICATION:	SINGLE, BI-PARTING, BYPASSING	DRAWING SCALE:	6" = 1'-0" (1:2)	<div>KROWNLAB</div> <div>2351 NW York St. Portland, OR 97210 +1 503 292 6998 www.krownlab.com support@krownlab.com</div> <div><div>KROWNLAB</div><div>PDF   GFF</div></div>
SYSTEM:	TRU-LEVEL™ TRACK	PANEL THICKNESS:	TROLLEY SYSTEM AND TRACK CONFIGURATION DEPENDENT	UNITS:	INCHES	
MOUNTING STYLE:	FRAMED WALL	MAXIMUM WEIGHT:	TROLLEY SYSTEM AND TRACK CONFIGURATION DEPENDENT	DATE:	11/14/2023	

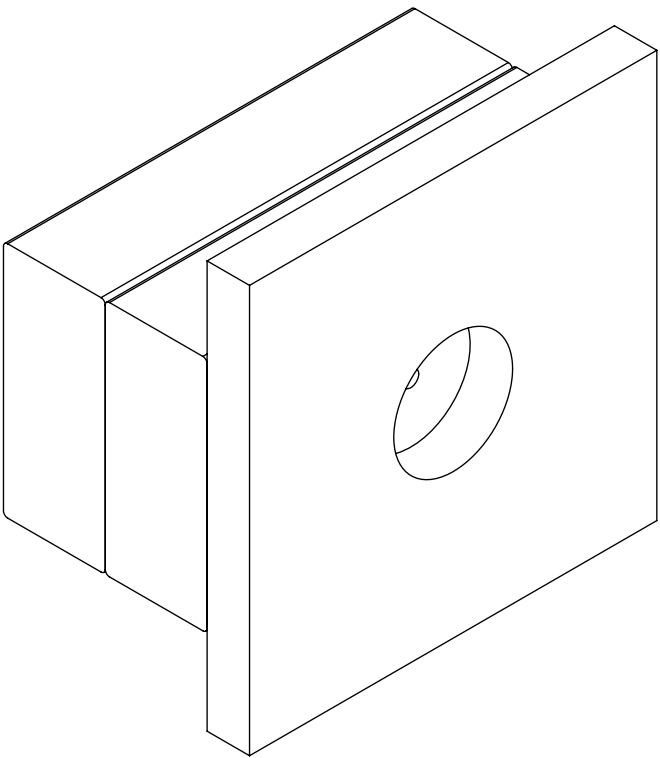
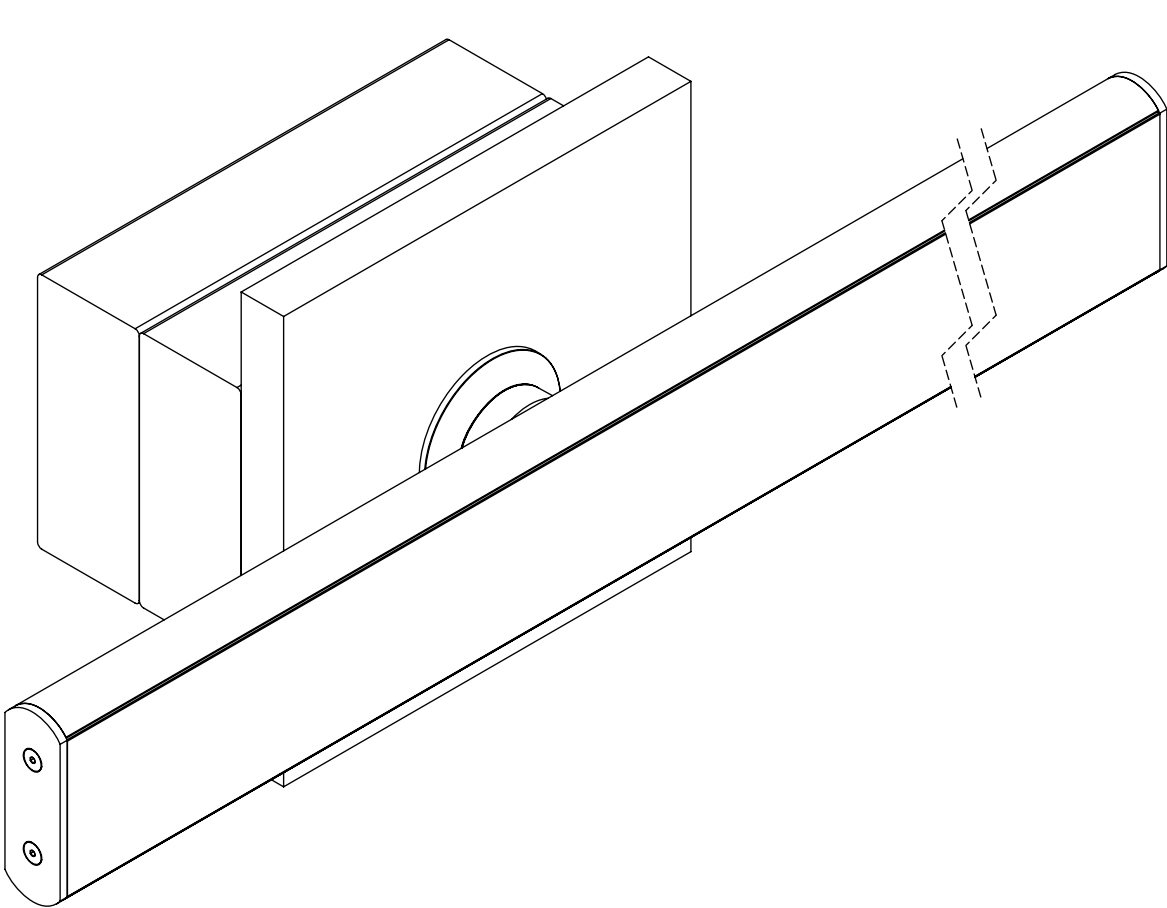
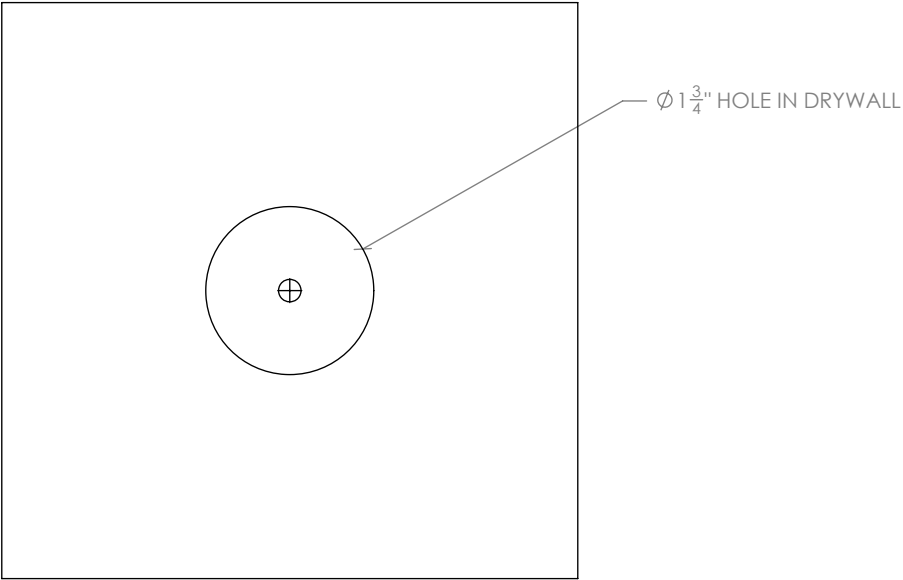
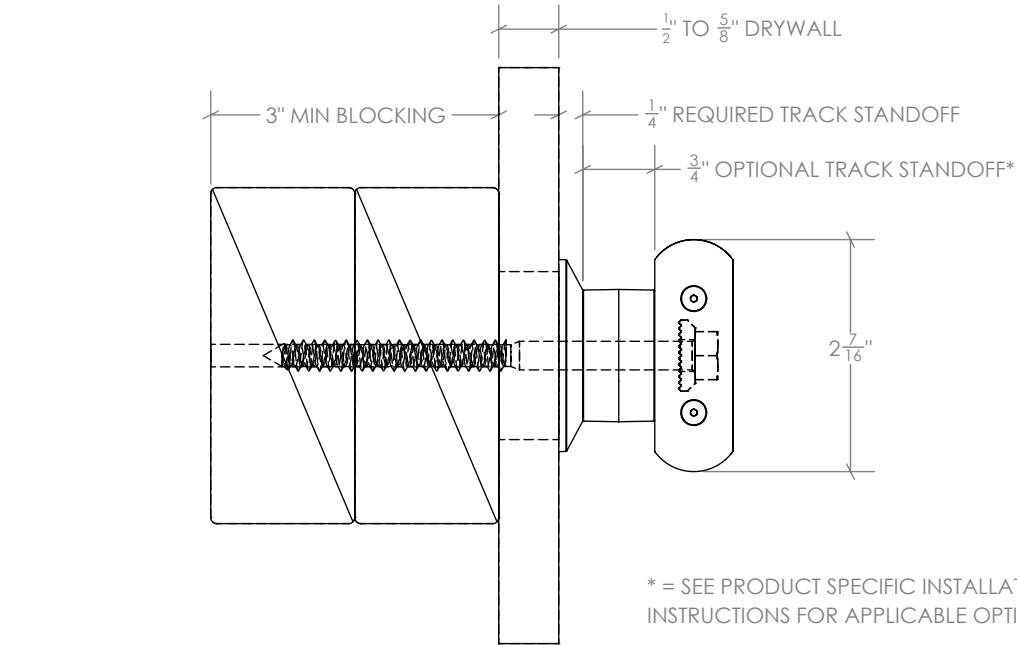

DOCUMENT:	PRODUCT SPECIFICATIONS - UNDRILLED TRACK DRILL PATTERN GUIDE	DOOR APPLICATION:	SINGLE & BI-PARTING	DRAWING SCALE:	1" = 1'-0" (1:12)	<div>KROWNLAB</div> <div>2351 NW York St.</div> <div>Portland, OR 97210</div> <div>+1 503 292 6998</div> <div>www.krownlab.com</div> <div>support@krownlab.com</div> <div><div><div></div></div><div>KROWNLAB®</div><div>PDR · DRE</div></div>
SYSTEM:	TRU-LEVEL™ TRACK	PANEL THICKNESS:	TROLLEY SYSTEM DEPENDENT	UNITS:	INCHES	
MOUNTING STYLE:	FRAMED WALL	MAXIMUM WEIGHT:	SEE BELOW	DATE:	3/6/2024	

STUD DRILL PATTERN: UP TO 250 LBS\* WITH 1" MAXIMUM TRACK STANDOFF. UP TO 200 LBS WITH 1-3/4" MAXIMUM TRACK STANDOFF.

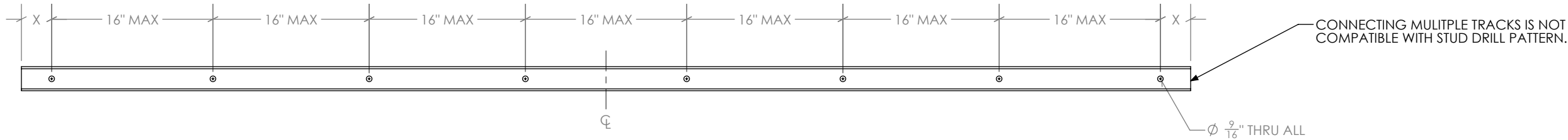

PANEL WEIGHT	X	MOUNTING POINTS
UP TO 100 LBS	5"	4 MINIMUM
101 TO 200 LBS	4"	6 MINIMUM
201 TO 250 LBS	3"	6 MINIMUM

"X" IS THE MAXIMUM LENGTH OF TRACK ALLOWED BEYOND END MOUNTING POINTS

STRUCTURAL BLOCKING DRILL PATTERN: UP TO 400 LBS\* WITH MAXIMUM 1" TRACK STANDOFF.

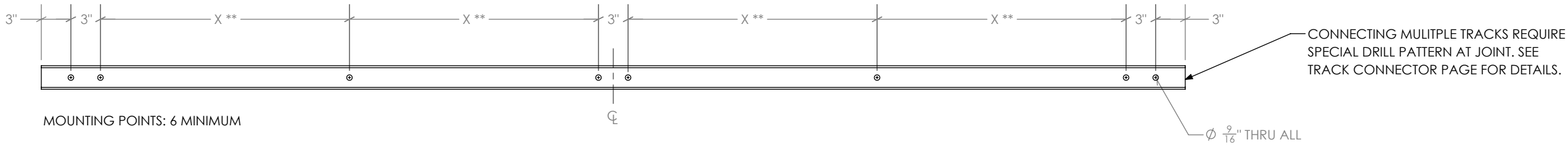

MOUNTING POINTS: 6 MINIMUM

\*\* = EVENLY SPACED

SPAN (X)	MAX. PANEL WEIGHT
UP TO 28"	200 LB.
UP TO 24"	400 LB.

\* WEIGHT LIMIT MAY BE FURTHER RESTRICTED BY TROLLEY SYSTEM

DOCUMENT:	PRODUCT SPECIFICATIONS - TRACK CONNECTOR	DOOR APPLICATION:	SINGLE & BI-PARTING	DRAWING SCALE:	6" = 1'-0" (1:2)	<div>KROWNLAB</div> <div>2351 NW York St.</div> <div>Portland, OR 97210</div> <div>+1 503 292 6998</div> <div>www.krownlab.com</div> <div>support@krownlab.com</div> <div><div>KROWNLAB</div><div>FOK · GFE</div></div>
SYSTEM:	TRU-LEVEL™ TRACK	PANEL THICKNESS:	TROLLEY SYSTEM AND TRACK CONFIGURATION DEPENDENT	UNITS:	INCHES	
MOUNTING STYLE:	ALL WALL TYPES	MAXIMUM WEIGHT:	TROLLEY SYSTEM AND TRACK CONFIGURATION DEPENDENT	DATE:	11/16/2023	

